

MIV Drain Plugs

Actual Picture



Performance:

- >Block ingress of wide range of contaminants, from rain and insects to dirt, dust, sand and other, particulates,
 - >IP 66, IP67 protection class and -40°C to $+125^{\circ}\text{C}$
 - >operating temp. range. Best to use under the tough environment.
 - >Installing on the bottom of enclosures or at side closed to bottom is effective for outdoor use.
 - >Breather plug with special filter which could drain the water droplet very easy.
- It is especially recommended for applications on outdoor enclosure under a heavy humidity environment. And it also already use a breather on the top side of enclosure. It will help to balance the pressure and help the liquid droplet drain out from drain plug easily.
- When there is water spray from outside, the valve inside drain plug will be closed for waterproof protection and recovery after no water spray or water pressure.

Dimensions for MIV-12DPB

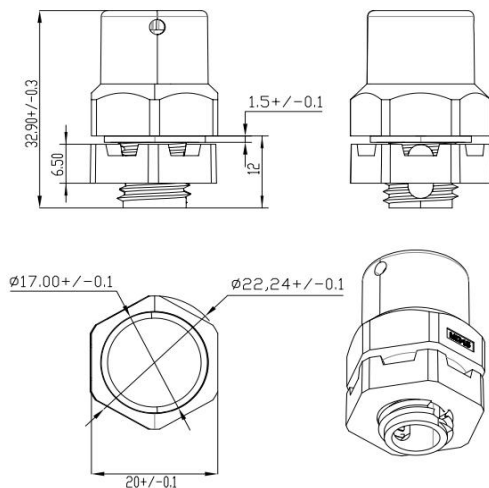

Application Installation:

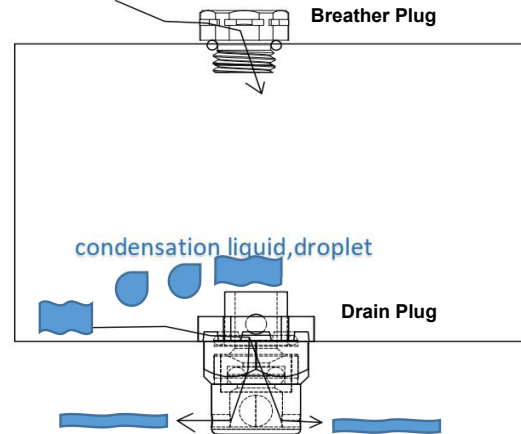

Assembly Hole: 12.1 +/- 0.1

Plastic

Metal

Part No.	Thread	w	TL	OD	Thread Length	Drain fit for Volume	Environmental performance
MIV-12DPB	M12x1.5	20	32.9	22.24	12	1L~3L	IP66, IP67 (Immersion: 1 meters/30 min.) -40°C ~ $+125^{\circ}\text{C}$ 85% humidity/1000 hours High temperature, Hail impact test. UL94V0 Torque: 0.7N.m Black Color
MIV-OW-12DPB	M12x1.5	20	26.56	22.11	10	1-10L	
MIV-OW-12DPB-MS	M12x1.5	20	26.56	22.11	10	1-10L	

Other sizes please check with us. We can OEM any sizes for you rapidly within 3 days.

www.milvent.com; milvent@milvent.com

+8618218369198

Dimensions for MIV-OW-12DPB

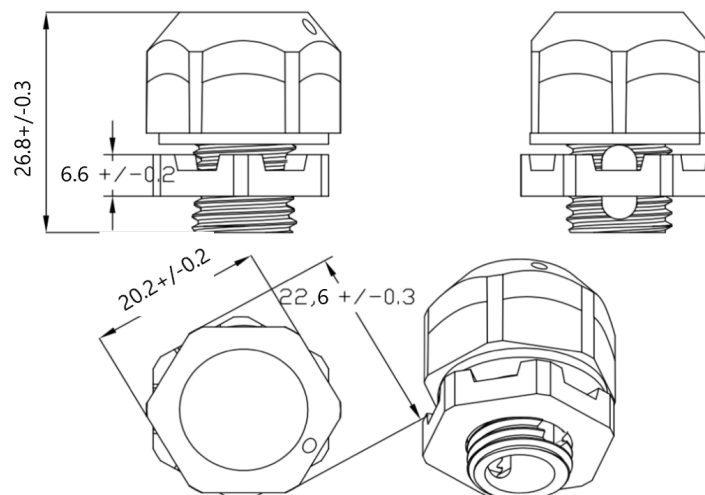

Material:

MS= Brass
MSUS=SUS
MA=AL